

Fire-Rated Panels For SIPs

ICC Tested 20-Min Thermal Barrier for Foam Panels

Blazeguard[®] adds ICC-level thermal barrier at less than installed cost of gypsum; saves time, labor, money at job-site

The International Code Council (ICC) requires a minimum 15-minute thermal barrier for inhabitable buildings using solid foam core insulation. Blazeguard offers a full 20-minute thermal barrier on either the interior or exterior face of a SIP (Structural Insulated Panel). Factory-applied and delivered on OSB SIP "skins," Blazeguard cuts job-site labor costs significantly while providing a surface ready for painting, finishing or texturing.



Blazeguard[®] (white face) protects the inside face of these commercial SIP roof panels in Ohio

Blazeguard[®] on a Structural Insulated Panel (SIP)

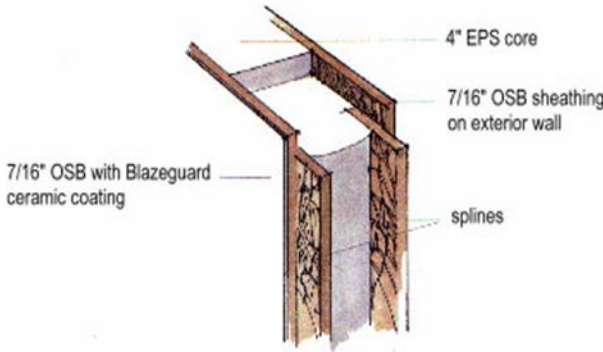

Blazeguard[®] For SIPs:

- ◆ 20-Minute Thermal Barrier (exceeds ICC requirement)
- ◆ Class A Flame Spread
- ◆ Impact Resistant
- ◆ UL Labeled
- ◆ ICC ESR-1365
- ◆ Factory Applied
- ◆ Environmentally Friendly

Blazeguard[®] can be applied to the interior face, exterior face or *both* faces of a SIP panel, depending on what level of fire protection is required or requested.

Three Common Ways to Fire Treat the Interior Face of SIP Panels

Type X gypsum wallboard	Approved fire-retardant paint	SIPs w/ Blazeguard
Highest Labor Cost	Requires Field Approval	Ready to Install

When all three methods are compared, Barrier's Blazeguard Fire-Rated Sheathing is the clear choice. Compared to gypsum or paint, Blazeguard fire treatment is:

- ◆ More highly tested and certified by IAC-accredited laboratories and building code agencies
- ◆ Lower cost (installed cost)
- ◆ Mold & mildew resistant
- ◆ Stronger panels
- ◆ UL Labeled and ICC code compliant (ICC ESR-1365) as thermal barrier for foam core insulation